



## 8 Aveling Way

Shireoaks, Worksop, S81 8FF

**£320,000**

A well appointment four bedroom detached home, situated on The grange; the popular new Harron Homes development in the sought after village of Shireoaks.

The accommodation briefly comprises: Hallway, Lounge, Cloakroom WC, attractively sized Kitchen diner with a host of integrated appliances, French doors accessing the patio and gardens and utility room. The garage has been converted offering a further reception room, still allowing convenient storage space/cupboard to the rear. On the first floor, four great size double bedrooms, a four-piece family bathroom suite and the master bedroom boasting fitted wardrobes and a generous sized en suite. To the outside; driveway and low maintenance garden to the front, with side access leading to a well maintained laid to lawn garden with patio area.

- Spacious four bedroom detached family home
- Two reception rooms
- Open plan kitchen diner
- Cloakroom W.C
- En Suite
- Gas central Heating
- Double Glazing
- Freehold
- Sought after village location
- Viewing highly recommended

### Viewing

Please contact our Office on 01302 751616 if you wish to arrange a viewing appointment for this property or require further information.

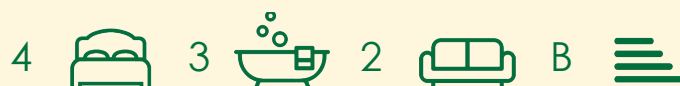



Floor Plan

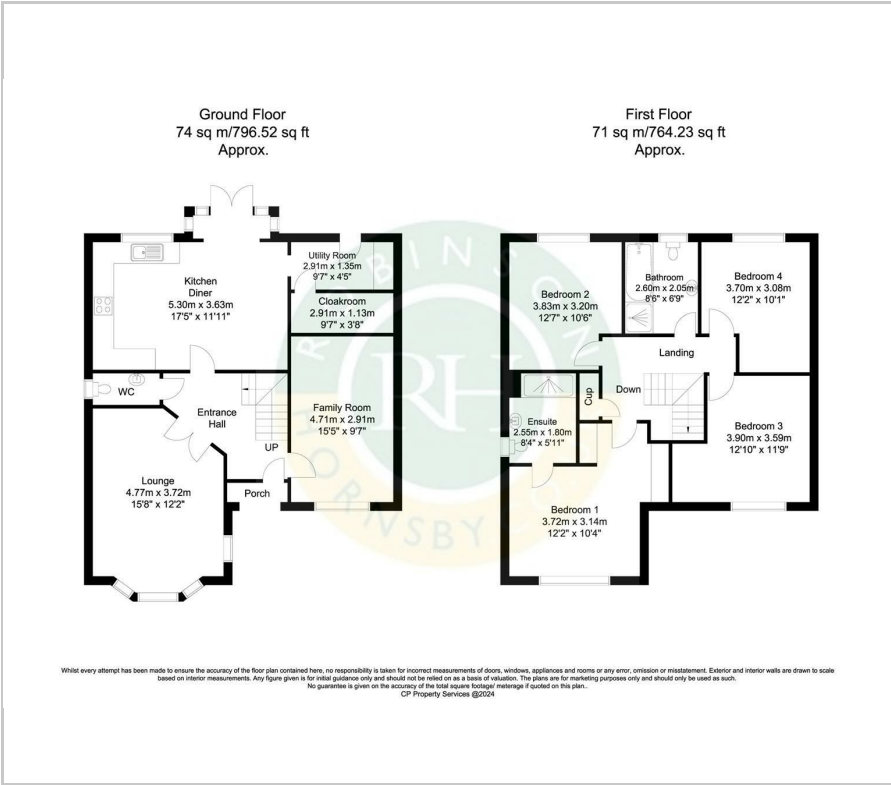

Area Map



Energy Efficiency Graph

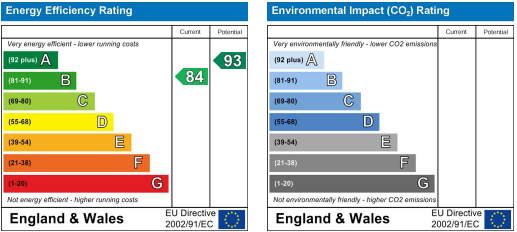

These particulars, whilst believed to be accurate are set out as a general outline only for guidance and do not constitute any part of an offer or contract. Intending purchasers should not rely on them as statements of representation of fact, but must satisfy themselves by inspection or otherwise as to their accuracy. No person in this firm's employment has the authority to make or give any representation or warranty in respect of the property.